

GS Trike Rack

gripsport[®]

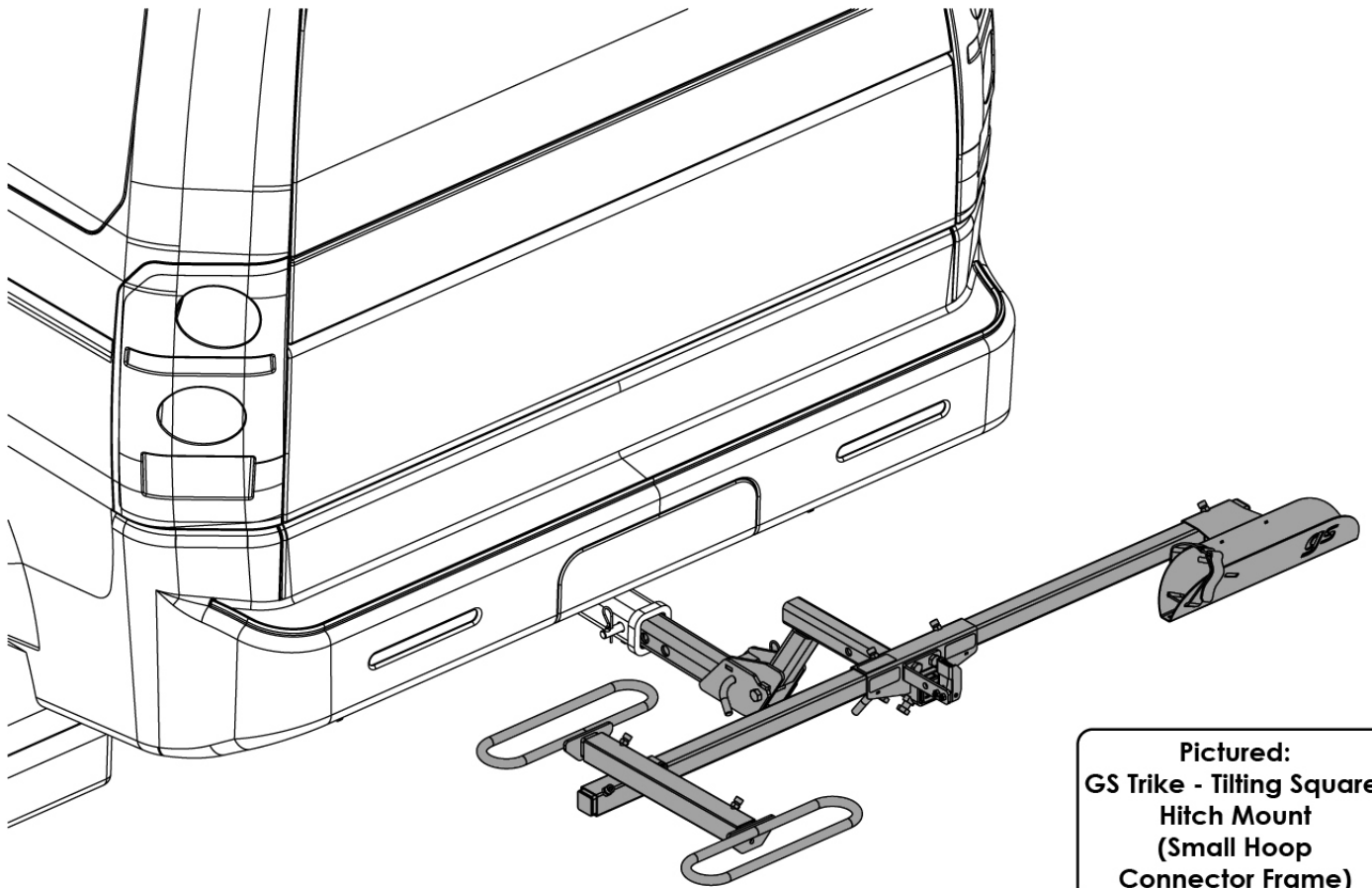

**Pictured:
GS Trike - Tilting Square
Hitch Mount
(Small Hoop
Connector Frame)**

Tools required:

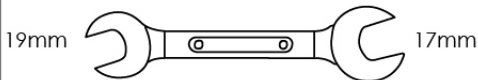

Rated: 1 x 50kg Trike
Square Hitch: Medium Off-Road use
Tongue Hitch: Light Off-Road use

Warranty:
5 year limited lifetime.
See all details online at:
www.gripsport.com.au/terms-conditions



facebook.com/gripsport.real



[@gripsportbikeracks](https://www.instagram.com/gripsportbikeracks)



bit.ly/GripSportVideos

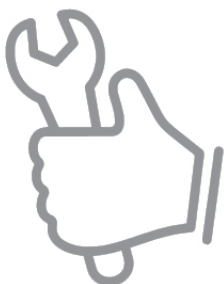

Hand tools assembly only.
Do not use power tools.



Read and refer to this manual to ensure correct assembly and installation.



Danger of accident and injury if these instructions are not followed. If unsure, contact gripsport or get a qualified installer to assist.



website info at:
www.gripsport.com.au

GS Trike Rack - Parts List

gripsport

GS Trike with Small connector frame shown.

Large connector frame also available.

All other parts, quantities and assembly process are the same.

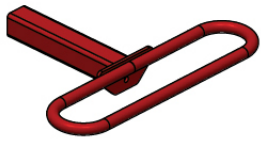

2 x Trike Hoops

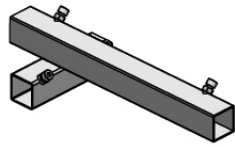

1 x Hoop Connector
Frame
(Small frame shown)

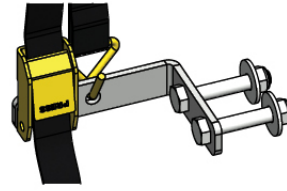

1 x Tie Down Bracket
with Strap

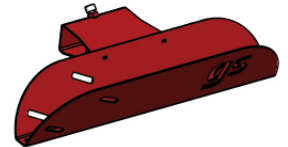

1 x "Taco" Wheel Channel
(Included in GS Adventure
Instructions)

GS Trike Rack - Assembly Instructions

This assembly guide is supplementary to the GS Adventure Assembly Instructions.

1. Replace Steps 2-5 of GSA Instructions.

- Insert Outrigger Arms into carrier mount & align holes
- Align tie down bracket holes with carrier mount and outrigger holes
- Insert 10mm x 60 long hex head bolts through all parts and washers and loosely fit nuts.
- Tighten all bolts in the sequence indicated below

(c) 10mm Nyloc Nuts
Loose fit at this stage

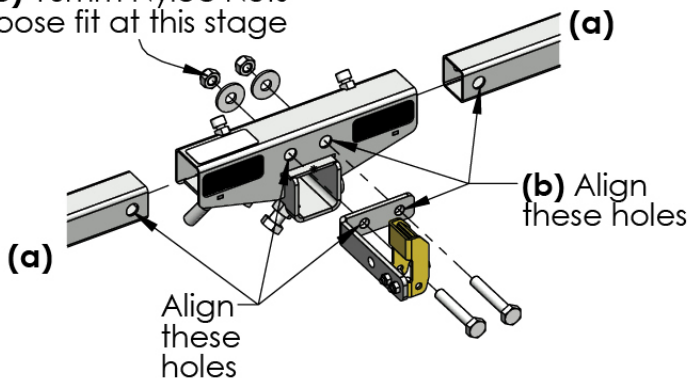

(d) Tighten all bolts in the following sequence

1. Allen Key Bolts
(requires 6mm allen key)

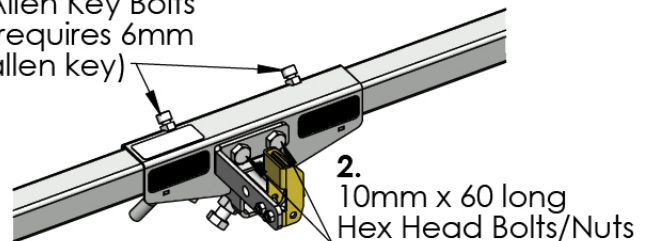

2. Insert trike hoops into frame connector and slide onto outrigger.
Slide "Taco" wheel channel onto outrigger

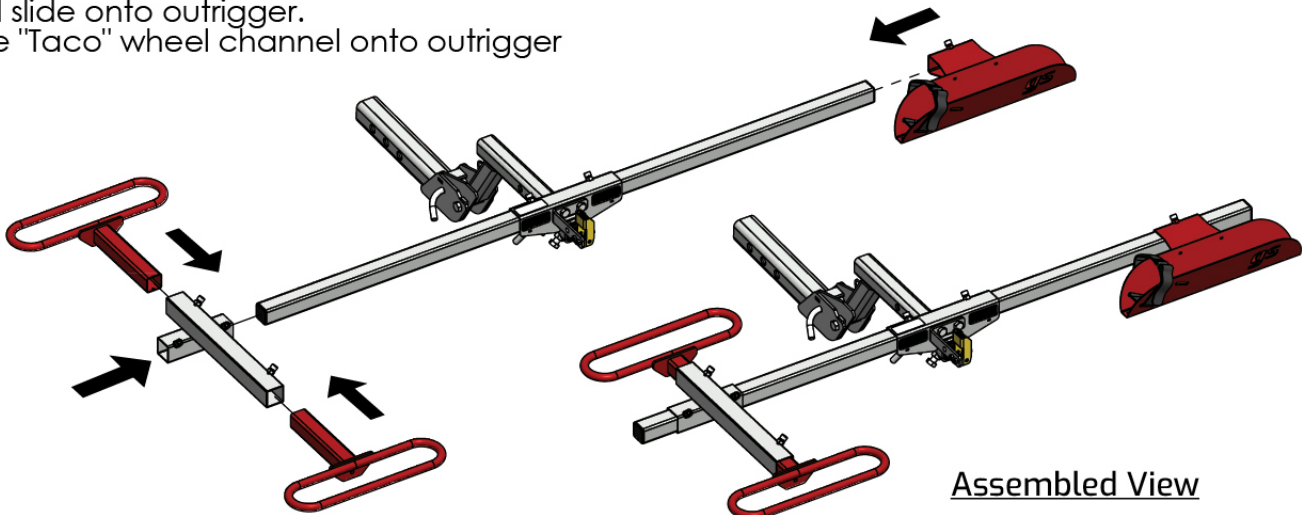

Loading Your Trike

To load your trike, follow these steps:

