

***gripsport***®

# Assembly Instructions

**GS4 & GS4+**

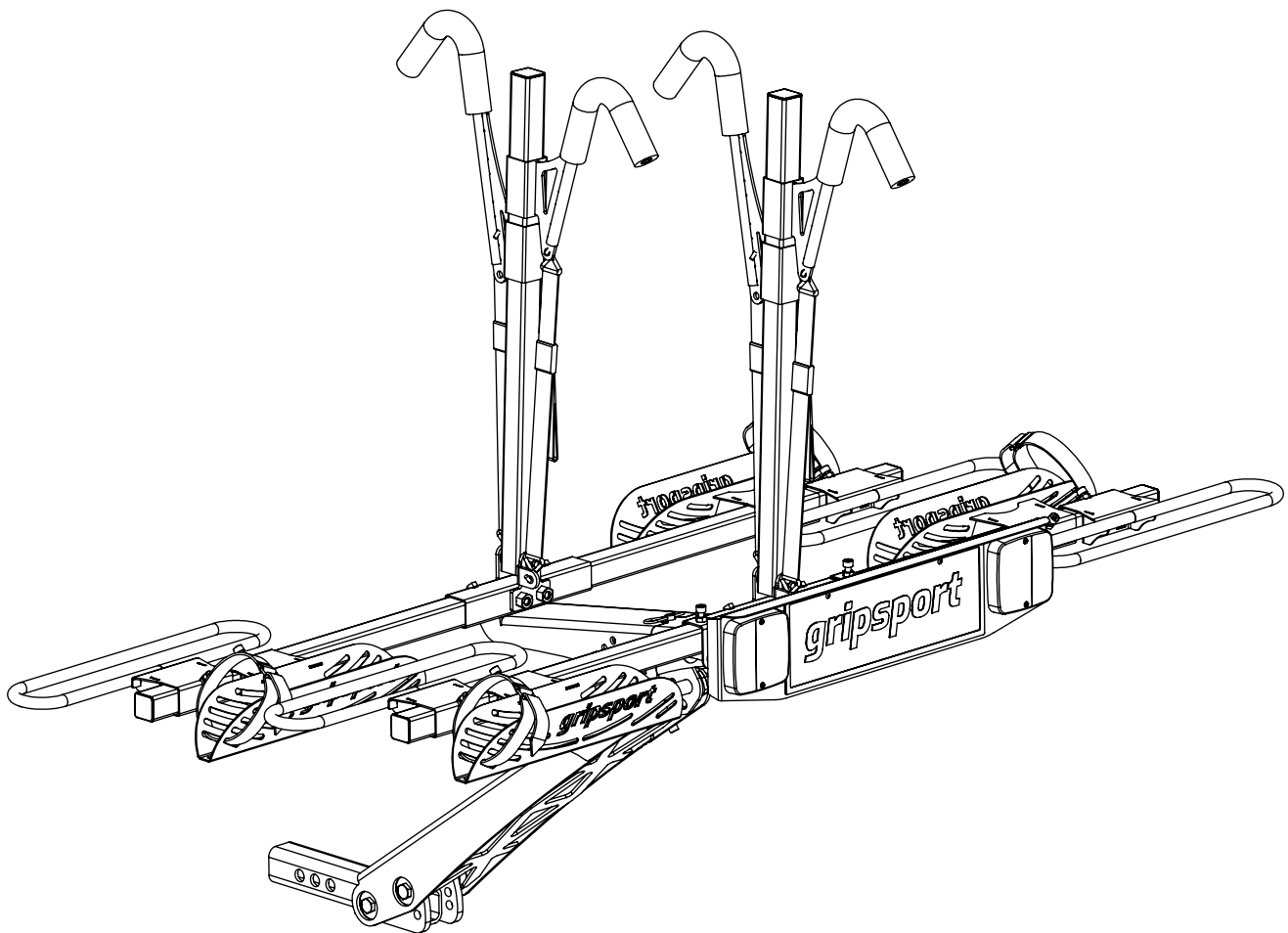

**Max 30kg per bike.**



# Parts list

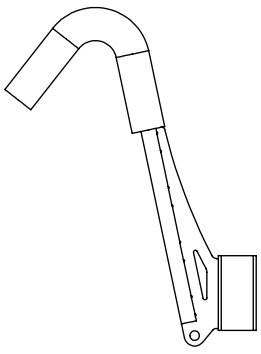

2 x Long Hook

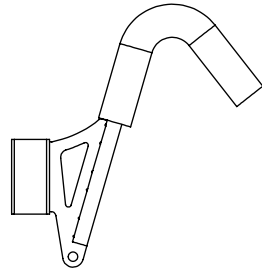

2 x Short Hook



4 x Tie Down Strap

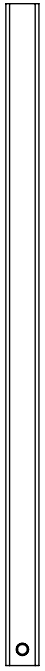

6 x Arms

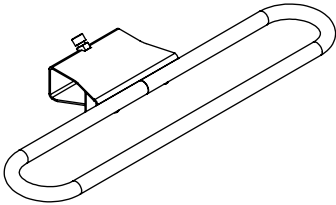

4 x Wheel Hoop

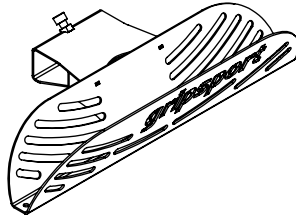

4 x Wheel Chanel



4 x Cinch Strap

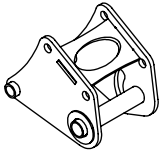

1 x Hinge

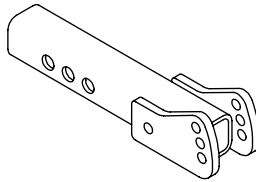

1 x Hitch Mount

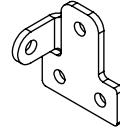

4 x Tab Plates



1x pin washer

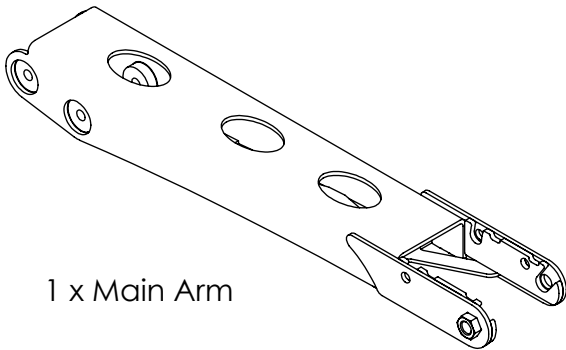

1 x Main Arm

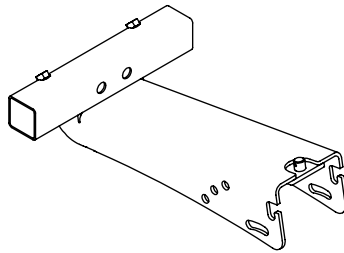

1 x Front Carrier Mount

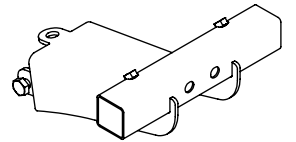

1 x Rear Carrier Mount

6 x 10mm x 60 long hex head bolt 

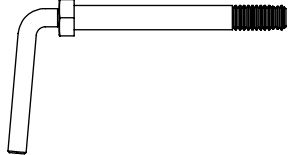
1 x threaded hinge pin 

2 x 10mm x 110 long hex head bolt 

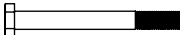
2 x 12mm x 110 long hex head bolt 

1 x safety pin 

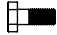
2 x 10mm x 25 long hex head bolt 

6 x 10mm washers 

4 x Large 10mm washers 

2 x 12mm nuts 

8 x 10mm nuts 

3 x R clip 

Rack light  
**GS4+ Only**

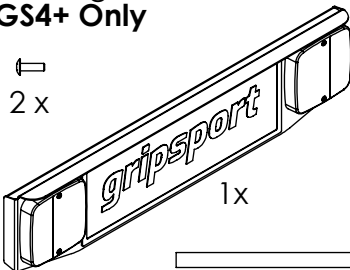

2 x

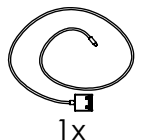

1x



1x

2 x



2 x

# Assembly

- Step 1.** Place 'Hitch Mount' into receiver of your vehicle,  
Select suitable hole position for your vehicle,  
Fit **your** hitch pin and tighten anti-rattle bolt if applicable.

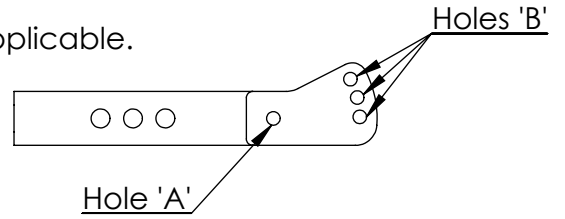

- Step 2.** Fit 'Main Arm' onto 'Hitch Mount'

- Align hole 'A' of hitch mount with hole 'A' of 'Main Arm' and insert 12mm x 110mm bolt.
- Select & align one of the three holes 'B' in the 'Hitch Mount' with hole 'B' in 'Main Arm' (this will govern the height at which your bikes are carried)
- Insert 12 mm x 110mm bolt.
- Fit nuts and **tighten both firmly.**

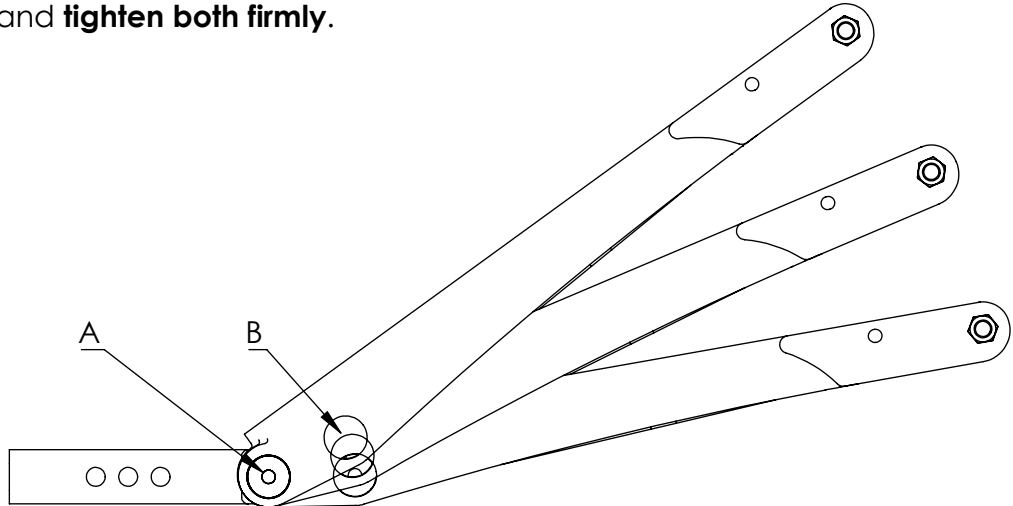

- Step 3.** Fit 'Hinge'

- Apply a small amount of oil or grease to faces A
- Fit Hinge in to Main Arm as shown.
- Fit Pin Washer to Threaded Hinge Pin.
- Insert Threaded hinge pin, ensuring that Pin Washer locates in hole as shown, tighten firmly & fit R clip.
- Insert Safety Pin & fit R clip.

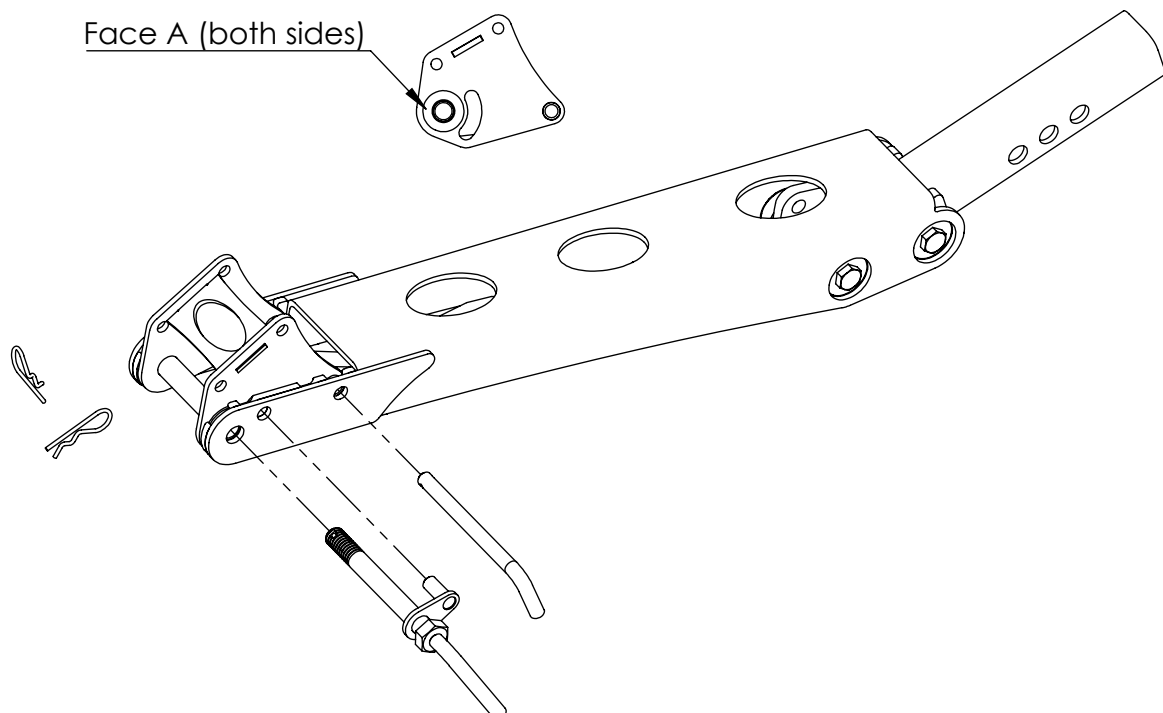

**Step 4.** Fit 'Front Carrier Mount'

- Align slot 'A' with hole 'A' & insert 10mm x 110 mm bolt with washer.
- Align hole 'B' with one of the three holes 'C', to set the angle of the 'Front Carrier Mount' (this has to match the position you chose at step 2, refer to diagram at bottom page and **ensure faces are parallel.**)
- Insert 10mm x 110mm bolt with washer.
- Fit washer and nuts & **tighten firmly.**

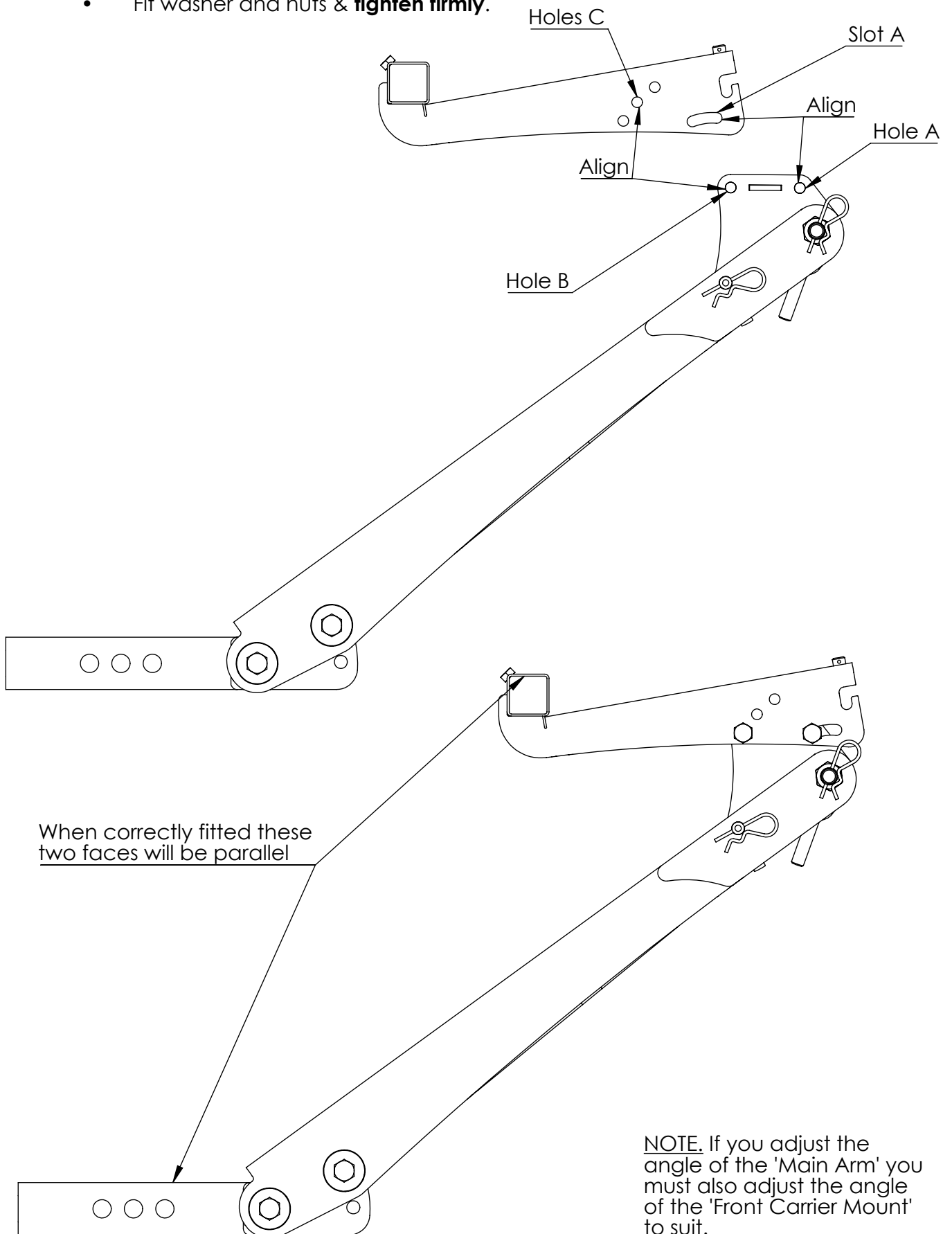

**Step 5.**

Fit 'Rear Carrier Mount.

- Align 10mm bolts with 'Slot A'
- Align 'Hole B' over locating pin
- Push down & insert R clip through Locating Pin
- Tighten 10mm bolts **Firmly**

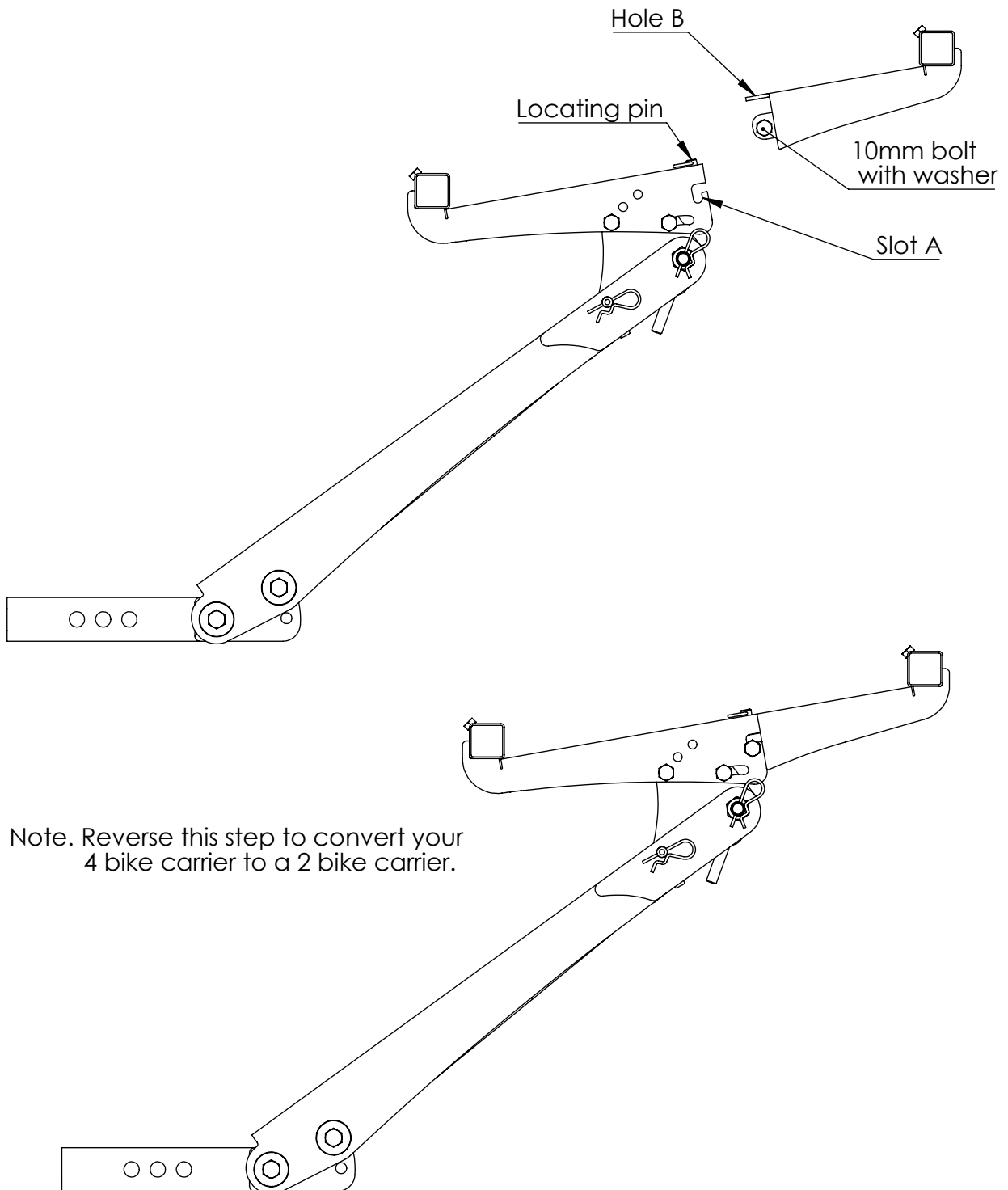

Note. Reverse this step to convert your 4 bike carrier to a 2 bike carrier.

**STEP 6.** Fit side arms & pivot arm to carrier

1. Loosely assemble the pivot arm.

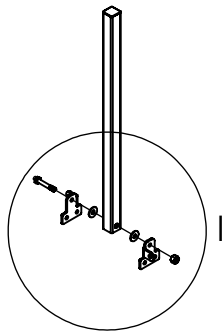

10mm x 60 long hex head bolt.

Arm. use any arm

Washer

10mm nut

Tab plates, note position of tabs.

2. Insert side arms in to carrier mount (ensure holes are aligned).
3. Place pivot arm assembly over carrier mount (ensure holes are aligned).
4. Insert 10mm x 60 long hex head bolts through all parts & fit nuts.

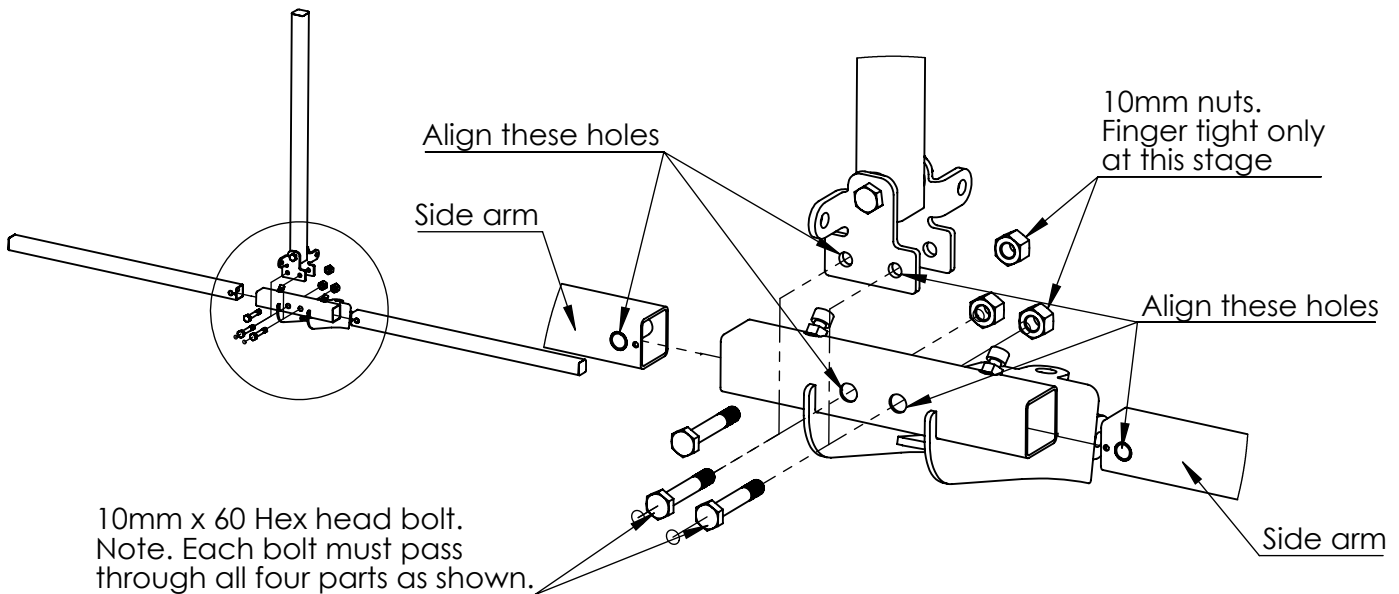

5. Tighten all bolts in correct sequence

**First.**  
8mm x 16 long allen key bolts  
(requires 6mm allen key)

Pivot arm

**Second.**  
10mm x 60 long hex head bolt

**Third.**  
10mm x 60 long hex head.  
Tighten until pivot arm is stiff to pivot from side to side

**Step 7.** Slide hoops & wheel channels onto arms as shown & tighten firmly (6mm allen key)

This configuration will suit the majority of bikes. You may need to alter this depending on your particular combination of bikes.

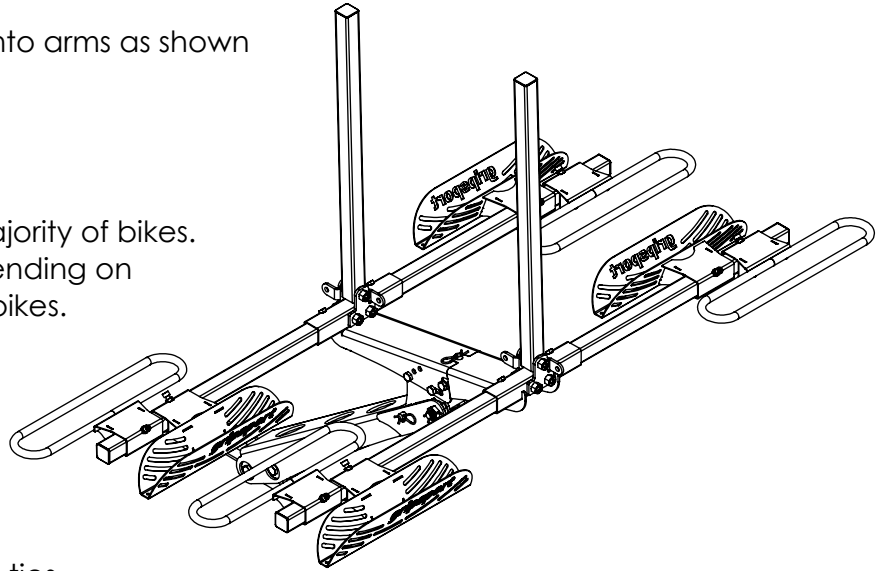
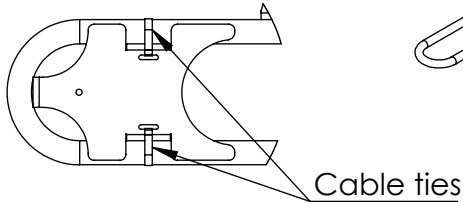

If using hoop reducers, fit as shown

**Step 8.** Assemble & fit rack light (GS4+ only)

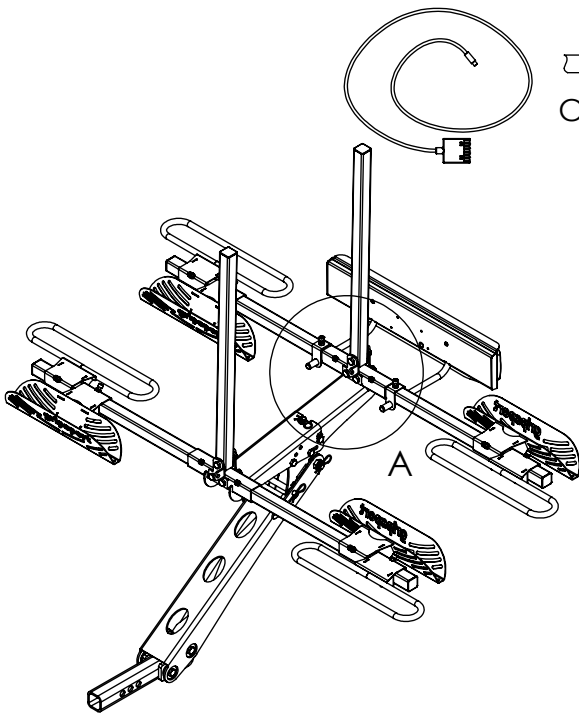

Connect plug to light board

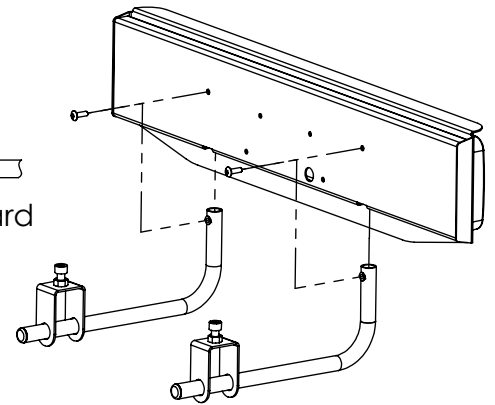

Rack light fitted to four bike set up.

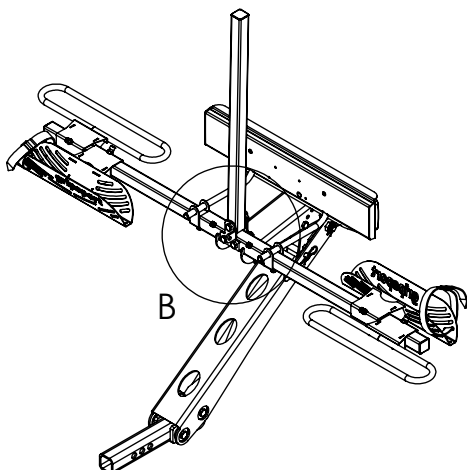
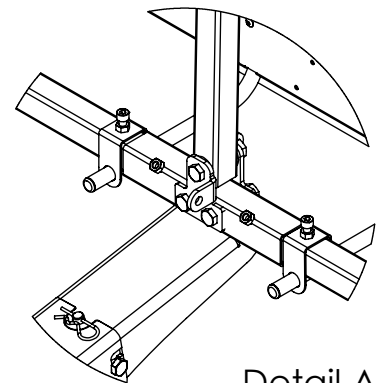

Rack light fitted to two bike set up.

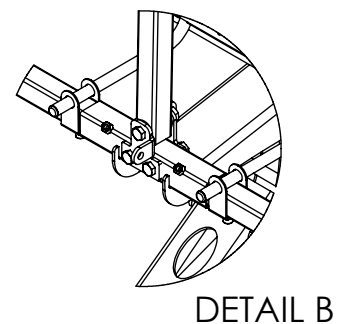

# Loading Bikes

Begin with the bike closest to the vehicle. (place heaviest bikes closest to vehicle)

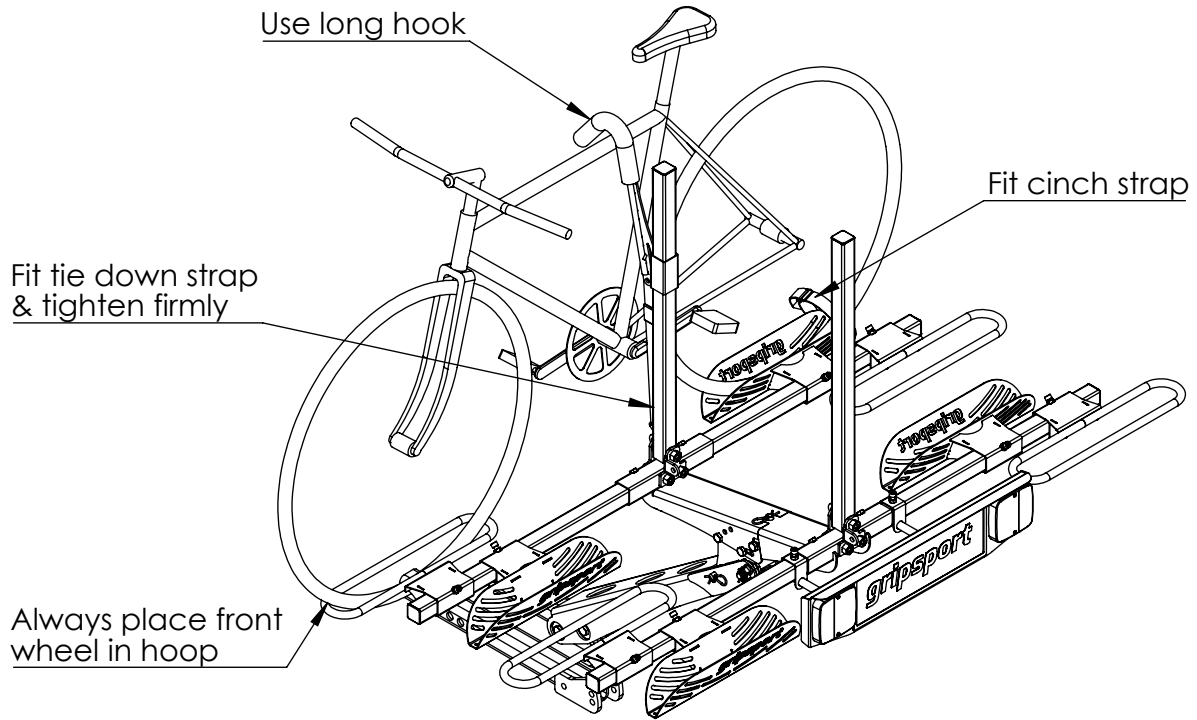

**NOTE.** If the pivot arm is only securing one bike the hook **MUST** be placed over the **LOWEST** point on the top tube.

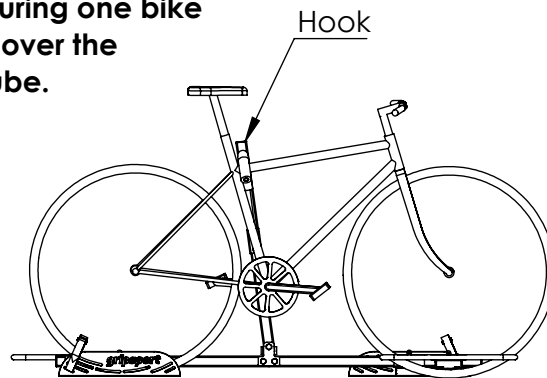

**NOTE.** Step-through (ladies) frames, must be fitted with a top tube adapter (not included)

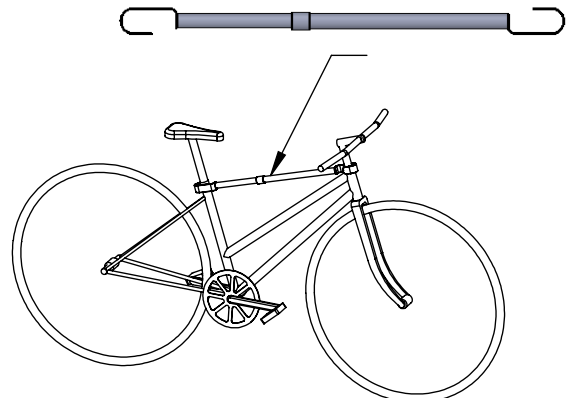



Load second bike

Use short hook

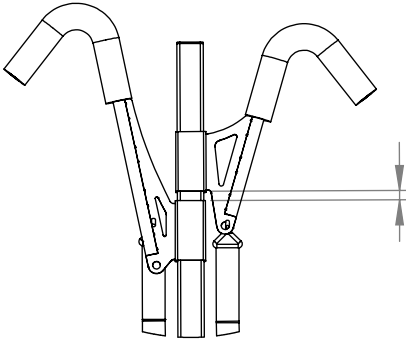
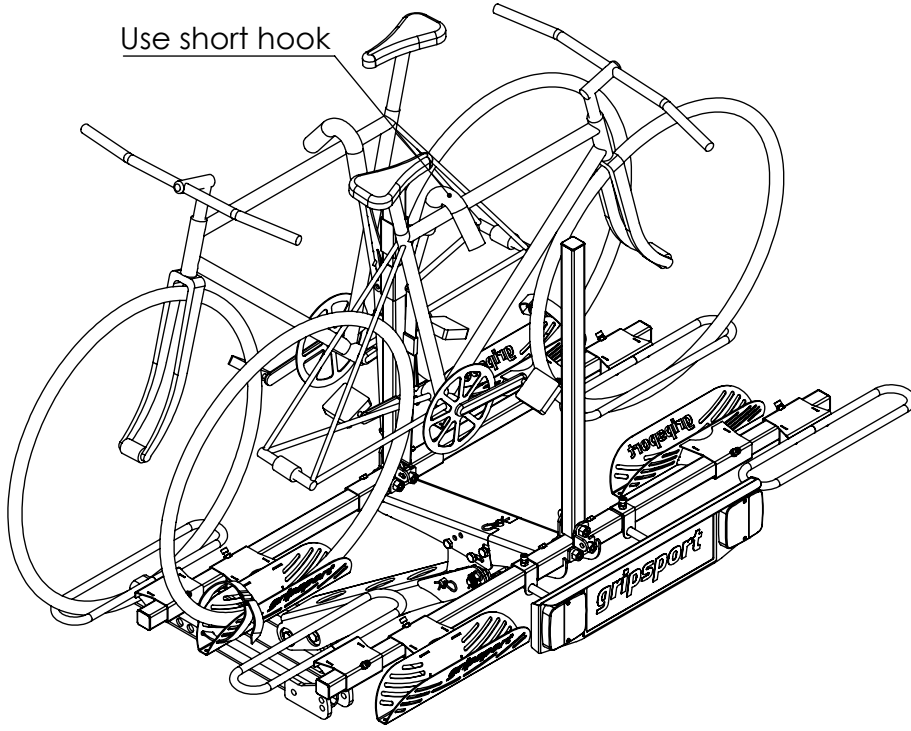

**Note. There MUST be a gap between the hooks  
Adjust position of pivot arm if necessary.**

Repeat process for bikes three & four

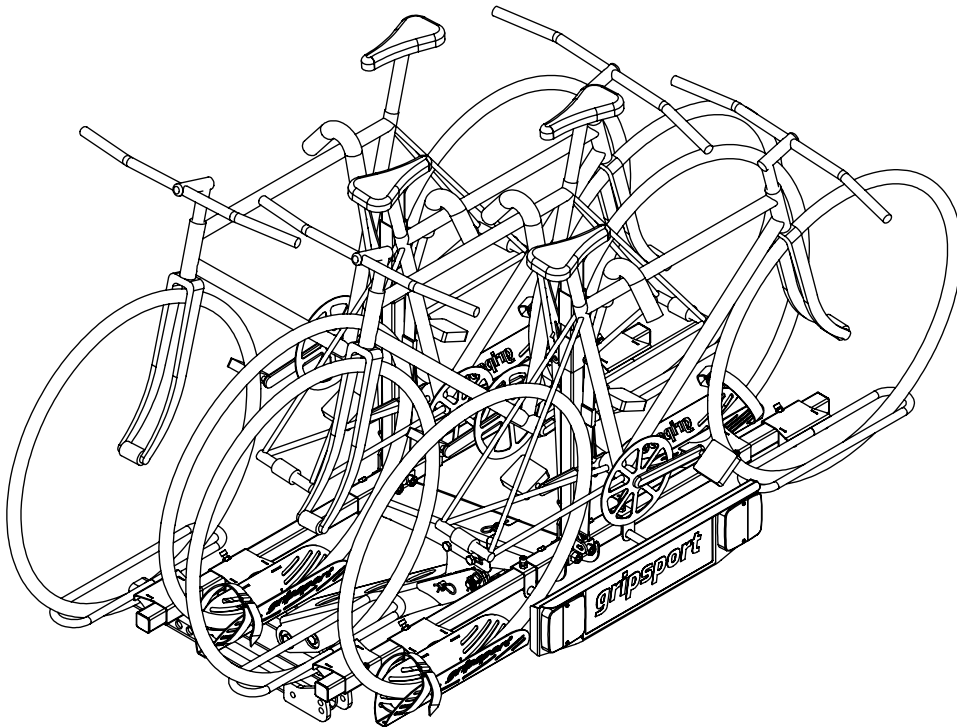

To tilt carrier

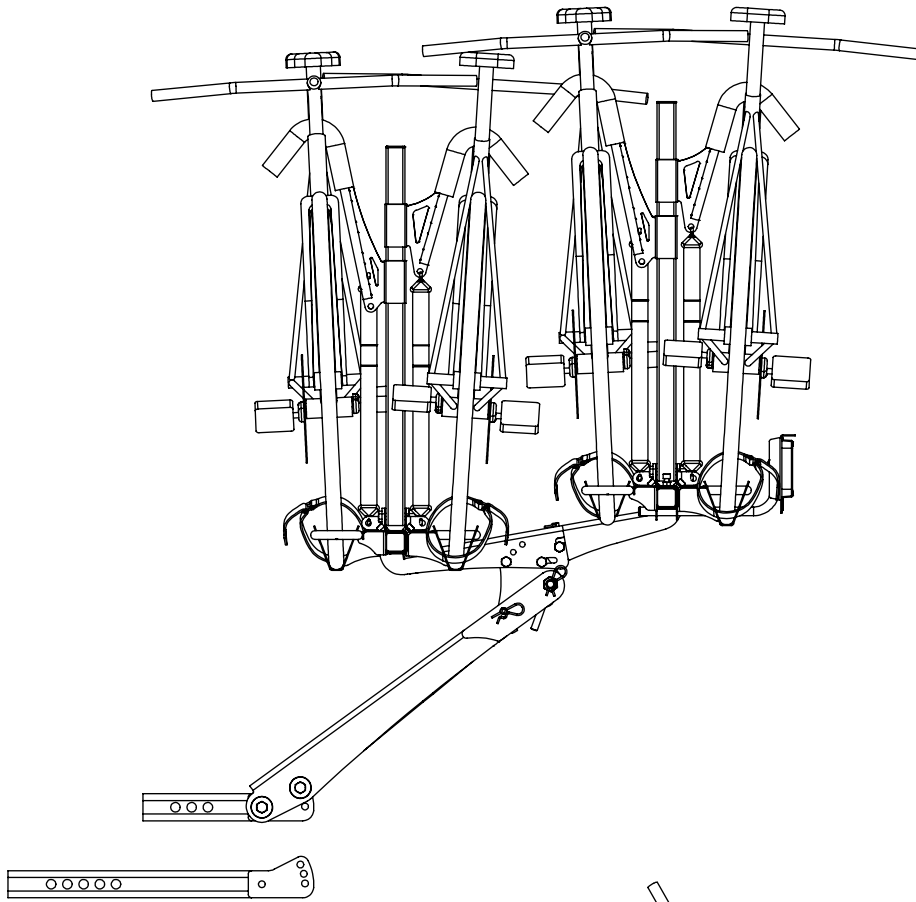

Remove R clip from safety pin.  
Remove safety pin.  
Tilt back.

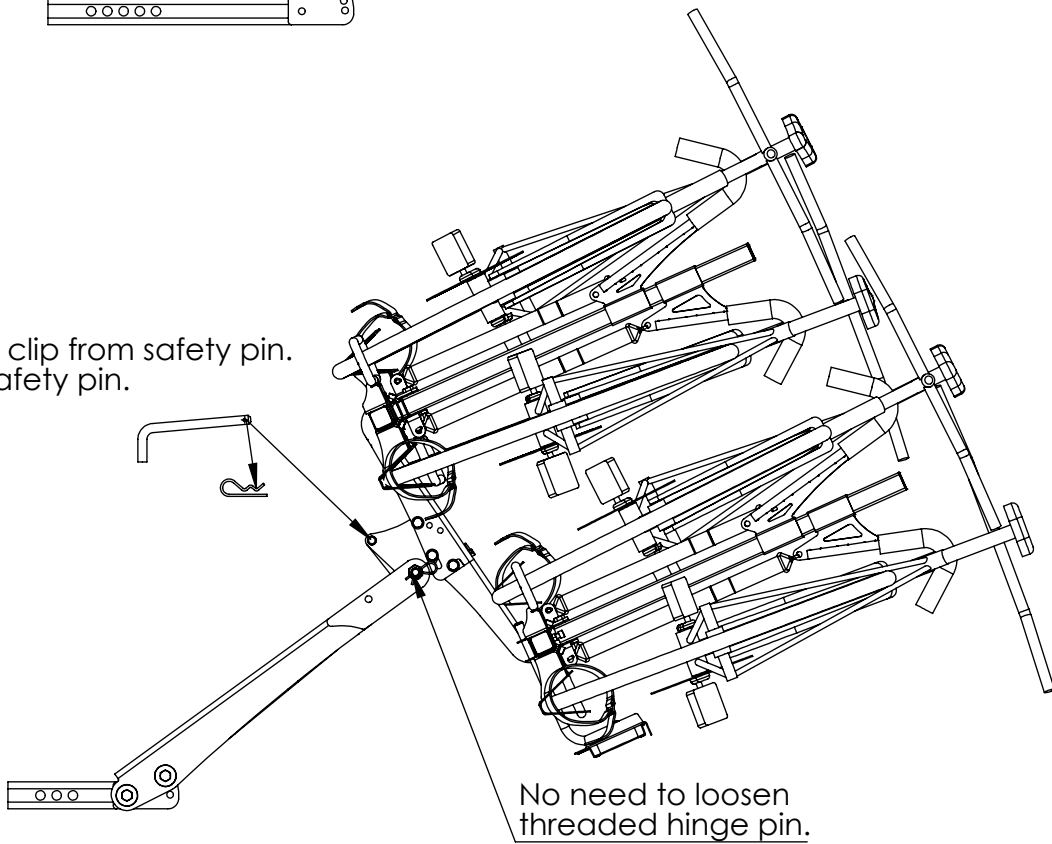

No need to loosen  
threaded hinge pin.

## Removing rack from vehicle

1. Fold pivot arms & hooks flat.

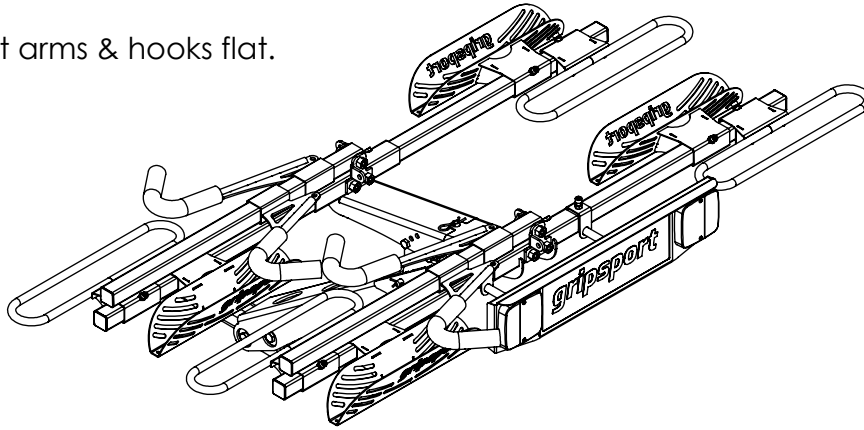

2. Remove R clips



3. Remove safety pin

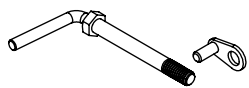

4. Remove Threaded hinge pin & pin washer

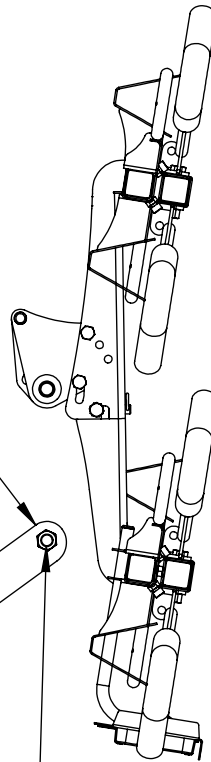

5. Tilt carrier to vertical & lift of main arm.

6. Remove main arm from vehicle receiver.