

BFS Bolted Floor Stand

Installation instructions

Suitable for all 2inch
Square Hitch Arm
Bike Racks



gripsport®

Pictured:
BFS with
GSA 2Bike rack



Required:

Hammer Drill

10mm
Masonry Drill Bit

13mm

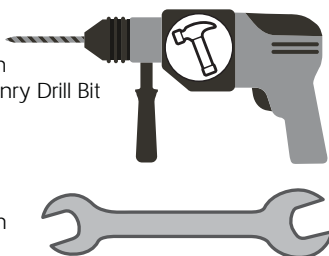

Ear Protection
Eye Protection



Danger

Risk of accident and injury if
these instructions are not
followed.

If unsure, contact GripSport or
get a qualified installer to assist.

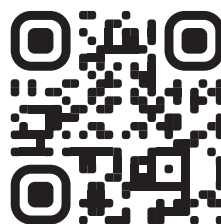

More product info at:
www.gripsport.com.au

Installation (DynaBolts)

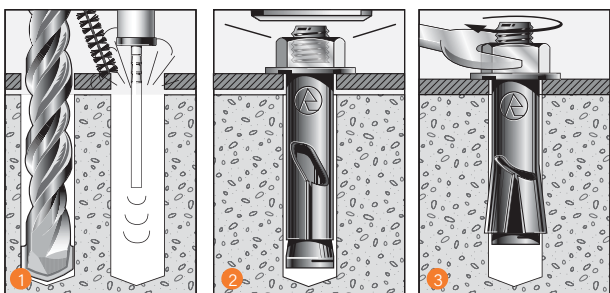

1. Use fixture as a template, drill a hole to the correct diameter and depth. Clean hole thoroughly with brush.
2. Remove debris by way of a vacuum or hand pump, compressed air, etc. Insert anchor tightly against fixture and tighten with spanner.
3. Continue tightening, allowing the sleeve to twist and pull down the fixture firmly onto the base material.

Credit: Ramset-SARB-ANZ-Ed.3-DynaBolt-Plus-SLEEVE-ANCHORS



facebook.com/gripsport.real



[@gripsportbikeracks](https://www.instagram.com/gripsportbikeracks)



bit.ly/GripSportVideos



BFS Bolted Floor Stand - Installation Instructions

gripsport

Parts List

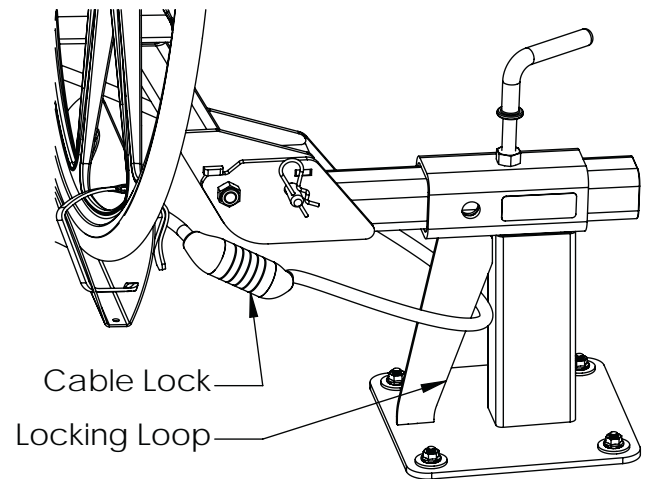
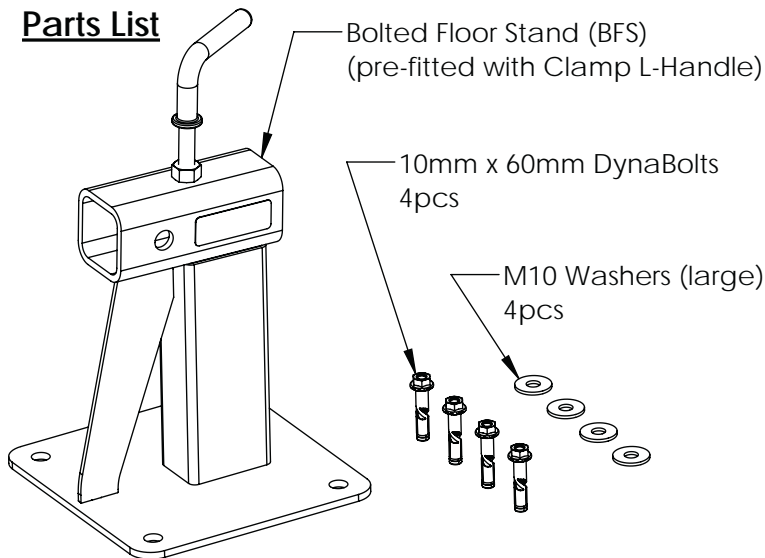

NOTE:

ONLY for bolting into LEVEL CONCRETE floor.
Do Not screw fix to timber floor or similar.

Cable Lock Loop

To secure Rack and Bikes, loop a good quality cable lock through the Locking Loop at the front of the BFS.

Step 1

With help from second person, lift your rack into BFS and roughly mark position on the concrete, ensuring loaded rack will give clearance to surrounding shelving, walls, etc.

Step 2

Remove Bikes & Rack, and accurately position and mark BFS installation position. Check **FRONT** as indicated below. Use BFS as a template and drill 4 holes 60-65mm deep. Use Hammer Drill with 10mm Masonry Drill Bit.

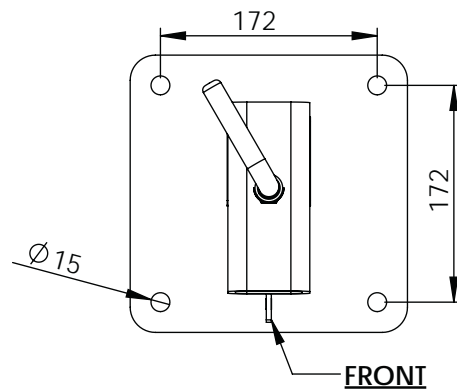
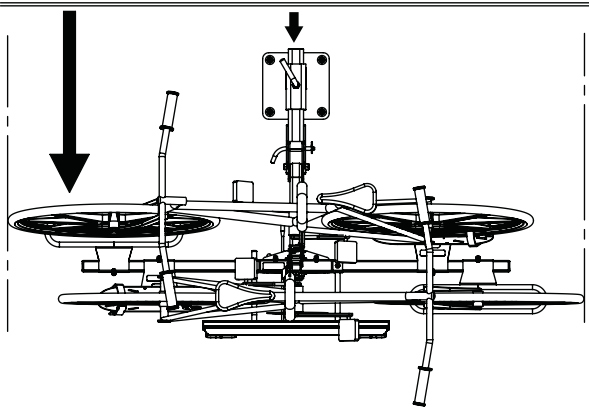

! Use PPE: !
Eye Protection
Ear Protection

Step 3

Remove dust/debris from holes with air or brush. Position BFS over holes, place Washers, then DynaBolts into holes. Hammer down DynaBolts until the Nut is against the Washer.

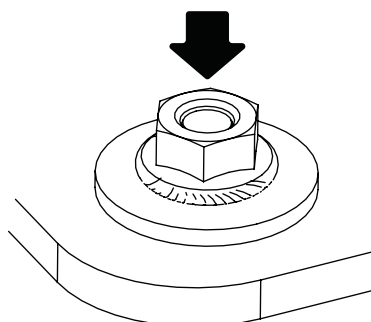
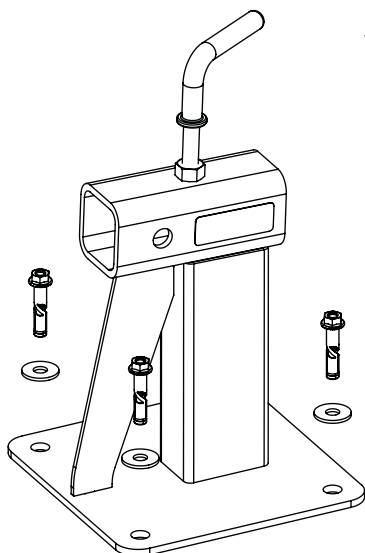

Step 4

Tighten DynaBolt Nut with a 13mm spanner. Tighten all 4 Nuts until very tight, and BFS is firmly mounted on the floor.

