

Hitch Stabiliser - Installation Instructions

gripsport

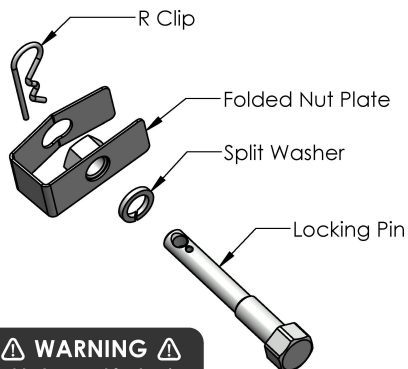

⚠ WARNING ⚠
Not to be used for towing
or recovery purposes!
For use on bicycle
carriers only.

Exploded View

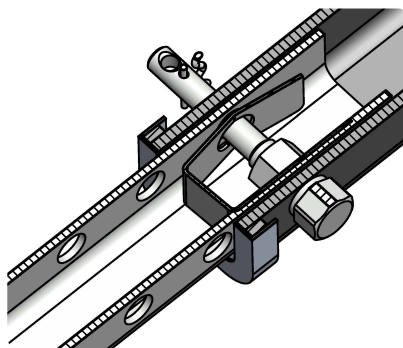

Finished Installation
3D Section View

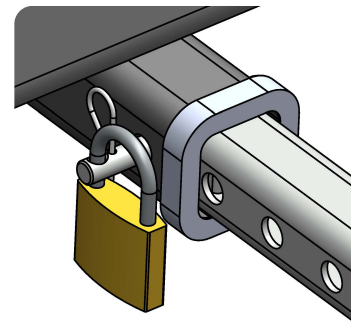

Optional Padlock
Fitted to large hole of Locking Pin
for added security.

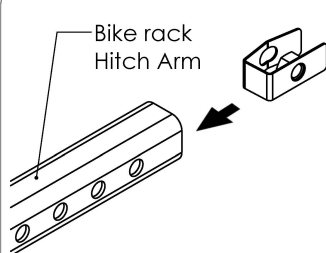

Step 1
Insert Folded Nut Plate
inside Hitch Arm. Fit at
desired hole position.

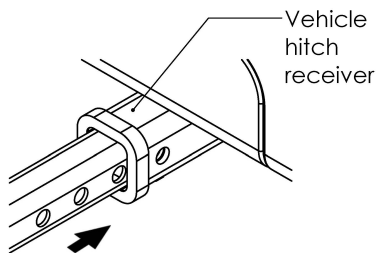

Step 2
Insert Hitch Arm into
vehicle hitch receiver,
up to selected hole.

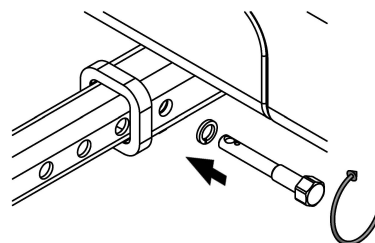

Step 3
Insert Locking Pin through Split Washer
& in to hitch receiver hole.
Tighten very firmly with 24mm spanner.

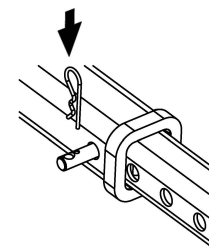

Step 4
Insert R Clip into small
hole of Locking Pin on
other side.